

Swivel castor 530 PT 50 P

Furniture Castors Series 530 PL - Wheel P

-20 °C - +60 °C

+++
swivels easily

+++
wear resistant

+++
shock proof

+++
floor protective

+++
weather proof

Wheel

Casted high quality nylon wheel black

High quality nylon housing - black

Swivel bearing with combined
plain-ball bearing

Wheel brake - glass fibre reinforced

Wheel axle revited

Swivel castor	Wheel-Ø A x width B mm: 52x8+8
Load Capacity kg:	40
Load capacity tested according to EN 12530 and EN 12527	
Overall height H mm:	63
Dimension of top plate TP	39x39
mm:	
Hole spacing HS mm:	30x30/24x24
Hole-Ø HD mm:	5,2
Swivel radius SR mm:	53
Wheel bearing:	Nylon plain bearing

Advantages

- ✓ easy running on smooth floors
- ✓ impact proof
- ✓ high abrasion resistance
- ✓ easy to clean
- ✓ high chemical resistance

©Copyright 2024 Rollenbau GmbH, www.rollenbau.at 20.05.2024

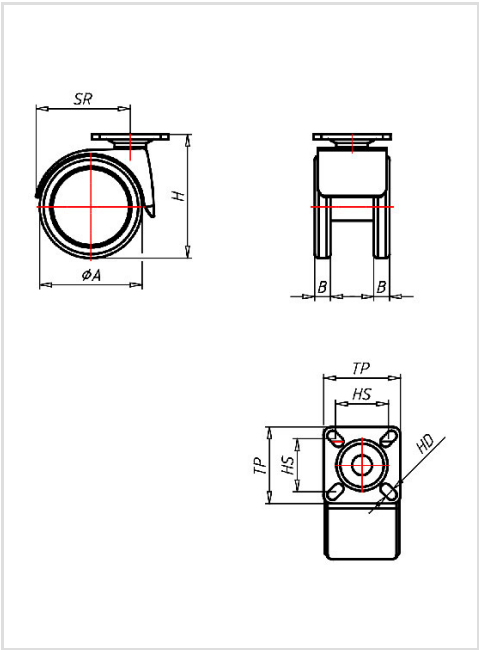

Applications

- Book carts
- Sidetables
- Laboratory equipment
- Instrument stands
- School furniture
- Bedside carts
- Health-Professionals